

Louisiana Association of
Substance Abuse Counselors and Trainers
July 30, 2013
Baton Rouge, LA

The College Party? Drinking and Drug Use Trends among College Students in Louisiana

.....
Bret J. Blackmon, M.A.
Associate Director

.....
Allison M. Smith, M. P. A.
Coordinator

Louisiana Center Addressing Substance Use in
Collegiate Communities (LaCASU)
Louisiana State University
3198 Pleasant Hall
Baton Rouge, LA 70803
lacasu@lsu.edu
www.lsu.edu/lacasu

A Little History...

- ⦿ Campus Coalition for Community Change (CCCC)
- ⦿ LA Center Addressing Substance Use in Collegiate Communities (LaCASU)
 - Louisiana Higher Education Coalition (LaHEC)
 - Baton Rouge Collegiate Alliance (BRCA)

**2013 LOUISIANA
CORE ALCOHOL AND DRUG
SURVEY**

Core Survey overview

- Behaviors, Perceptions, and Consequences Related to Substance Use among College Students
- Core Institute – Carbondale, IL
- 4th administration (2007, 2009, 2011, 2013)
- March 4 – 30, 2013
- Funding Source (DHH-OBH)

What does the Core Survey Process look like?

- ① Identifying liaisons at each institution
- ① Obtaining IRB approval
- ① Survey administration
- ① Dissemination of results

Sample

- ⦿ N = 7,740 students
- ⦿ 22 Institutions of Higher Education
 - 5 community or technical colleges
 - 17 four-year institutions

Survey Demographics

Classification

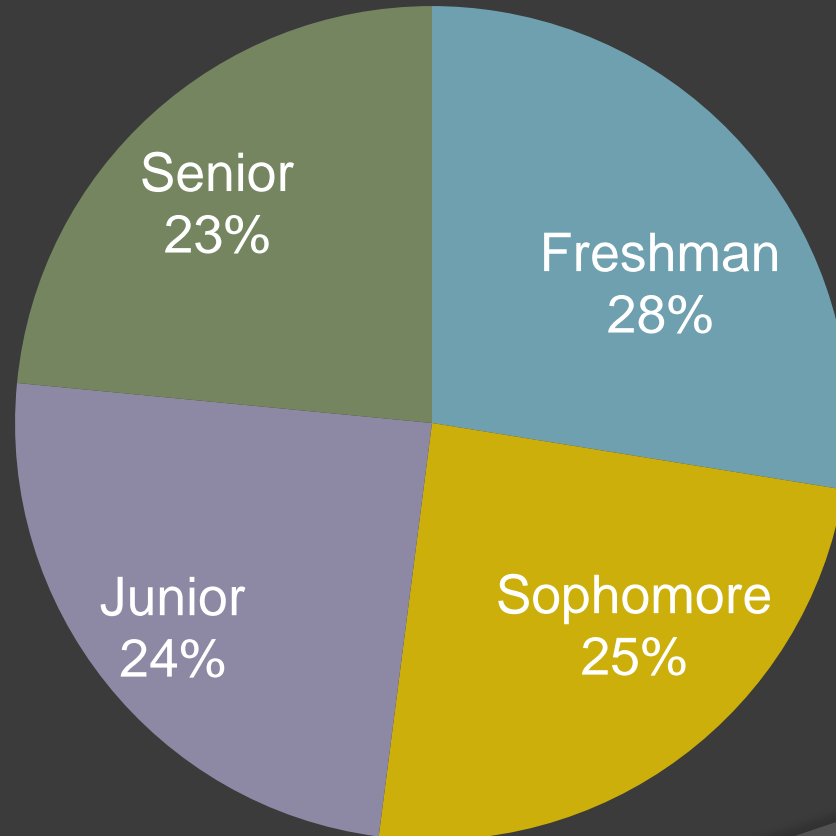

Survey Demographics

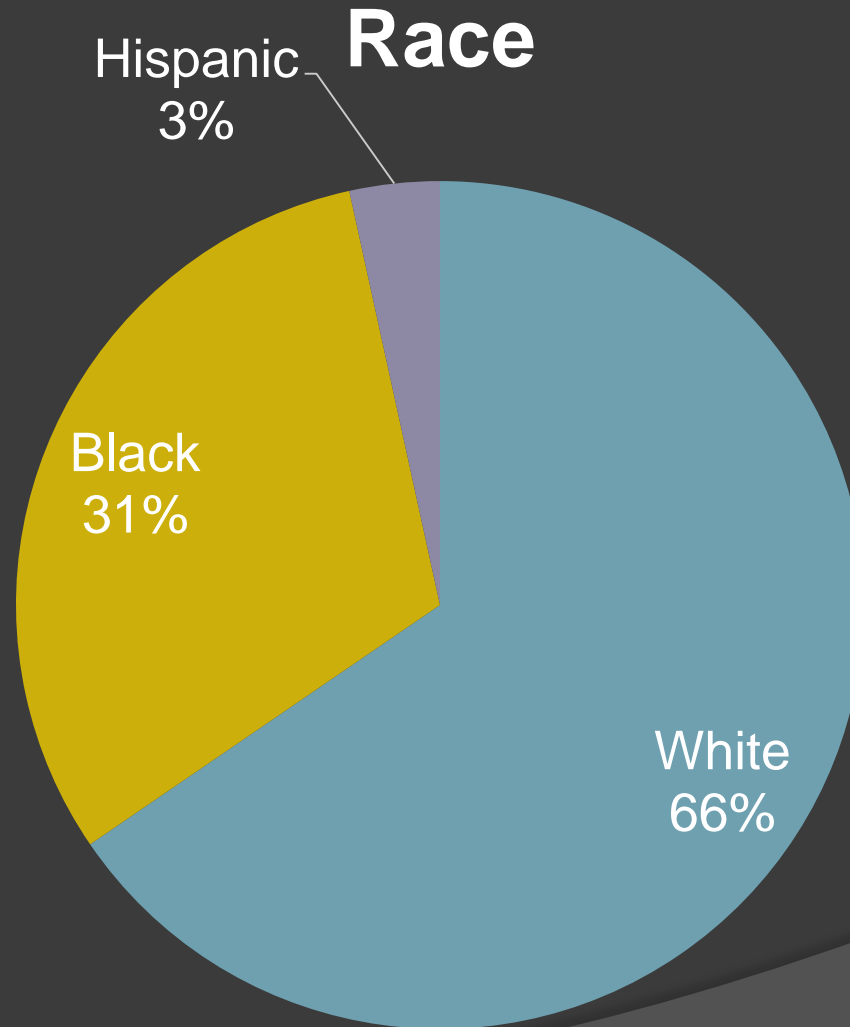

ADMINISTRATION:

Spring 2009, Spring 2011, and Spring 2013

	2009	2011	2013
Total Number of IHEs	33	35	22
Four-Year Universities	19	21	17
Two-Year Universities	7	6	4
Technical Colleges	7	8	1

Louisiana Consortium

2013 Core Alcohol and Drug Survey, Statewide Results

Groups

State vs. National

OBH Regional Comparison

Issues

Alcohol Use (30 days)

Binge Drinking (2 weeks)

Tobacco

Marijuana Use

Other Drug Use (non
marijuana)

Question #1: Louisiana vs. United States

Which has the higher 30 day use in the following:

- ⦿ Alcohol
- ⦿ Tobacco
- ⦿ Marijuana
- ⦿ Other Illegal Drugs

State vs. National: 30-Day Alcohol Use

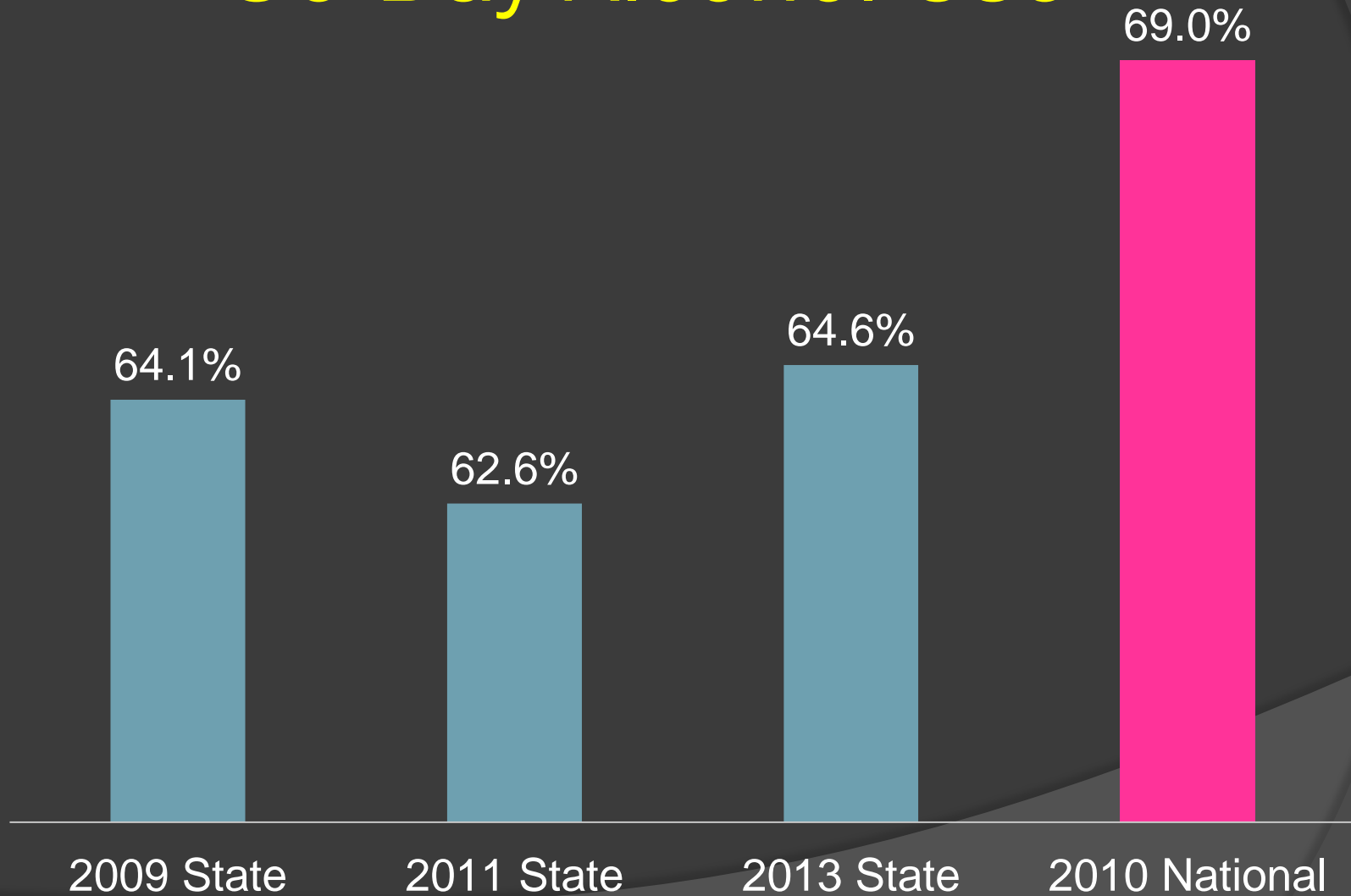

State vs. National: 30-Day Tobacco Use

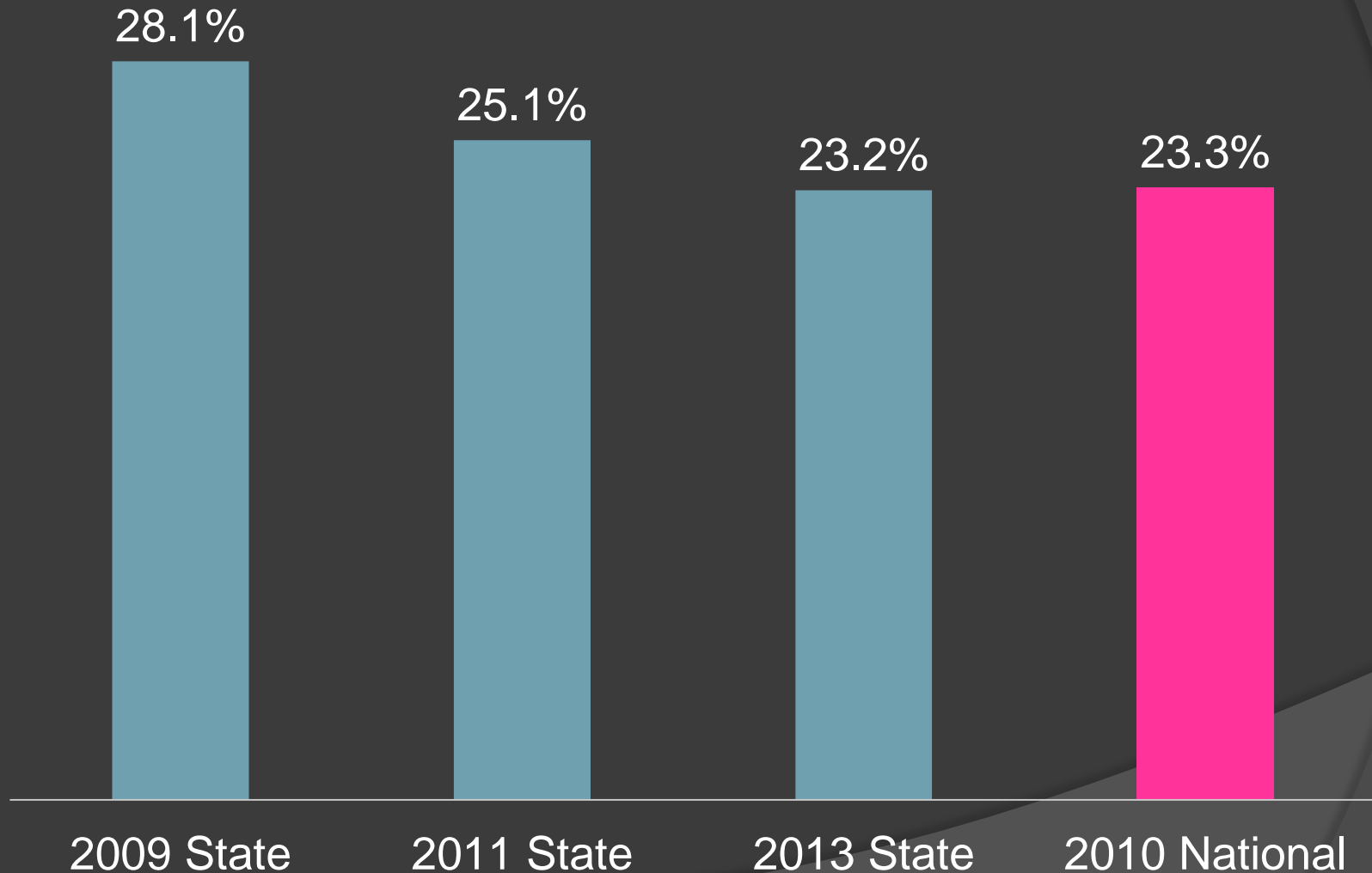

State vs. National: 30-Day Marijuana Use

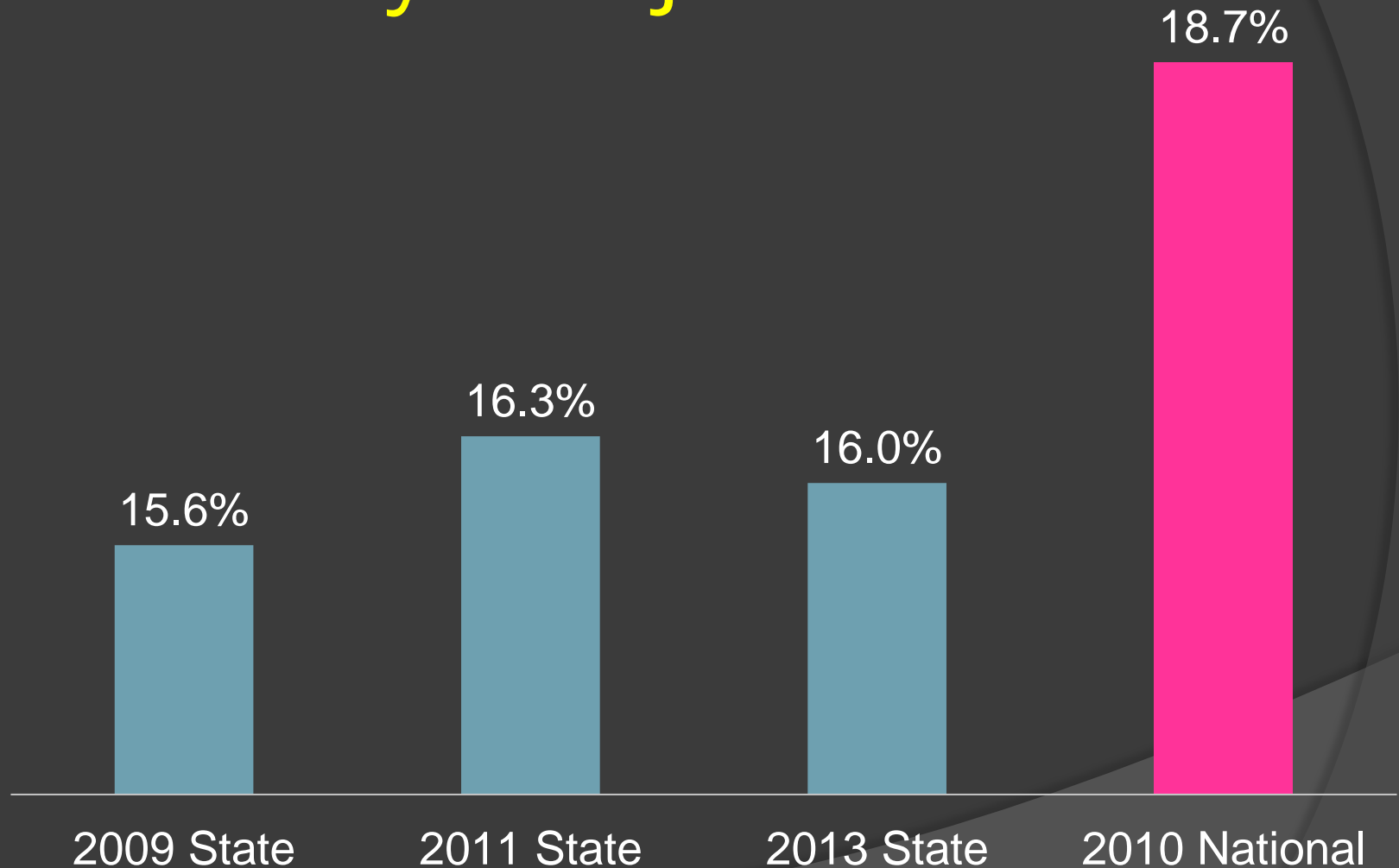

State vs. National: 30-Day Other Illegal Drug Use

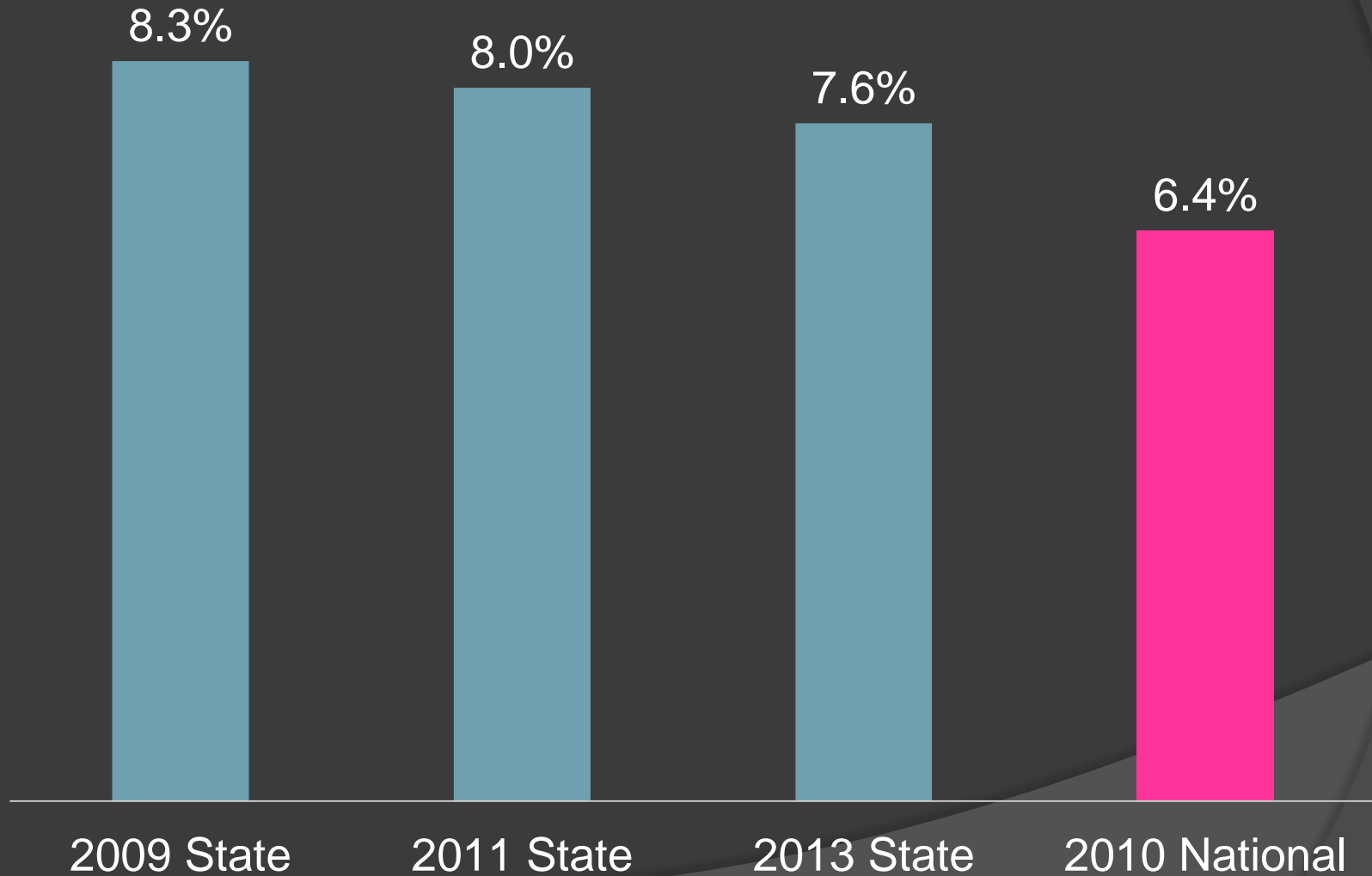

State vs. National: Binge Drinking

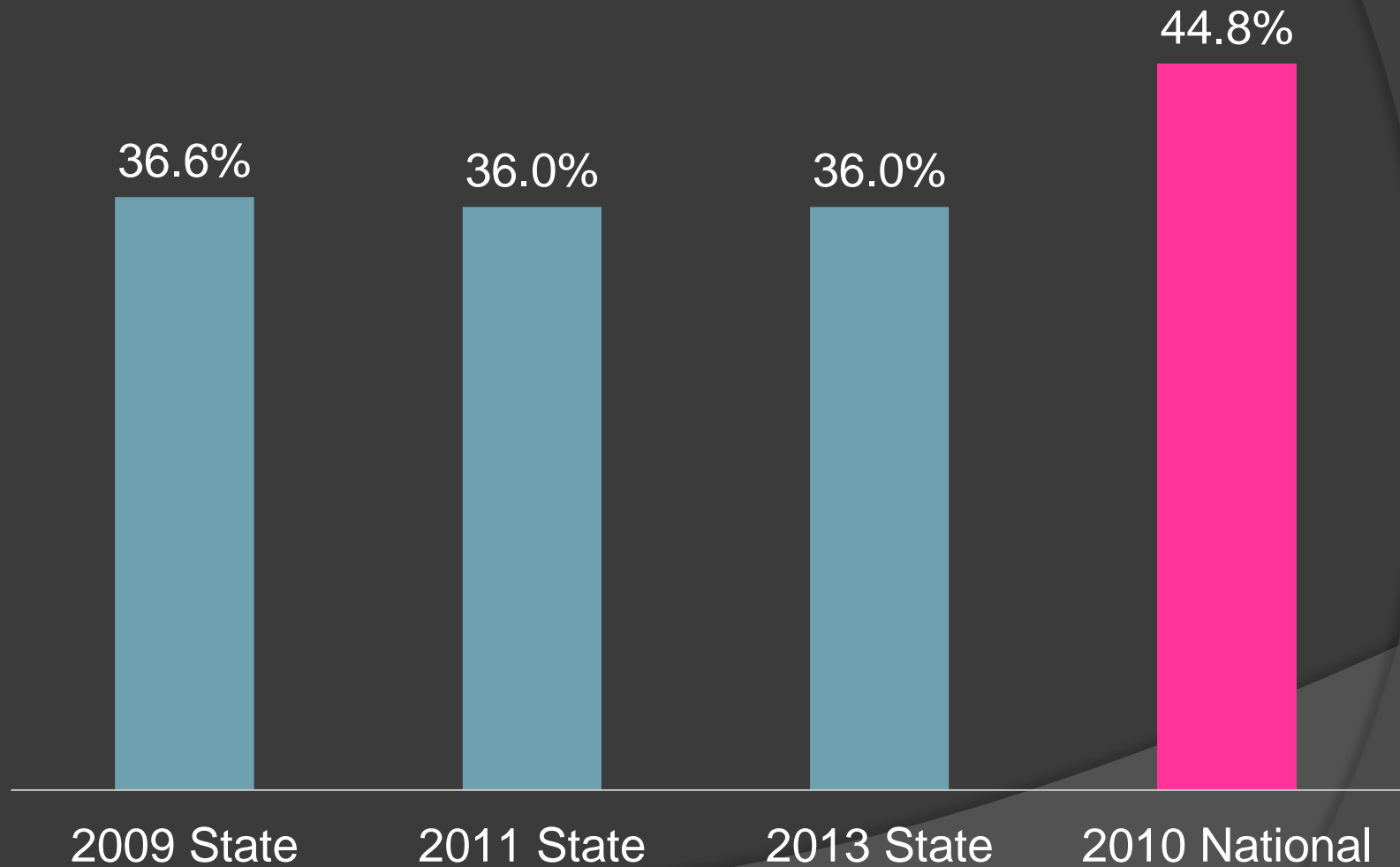

Driven a car while under the influence

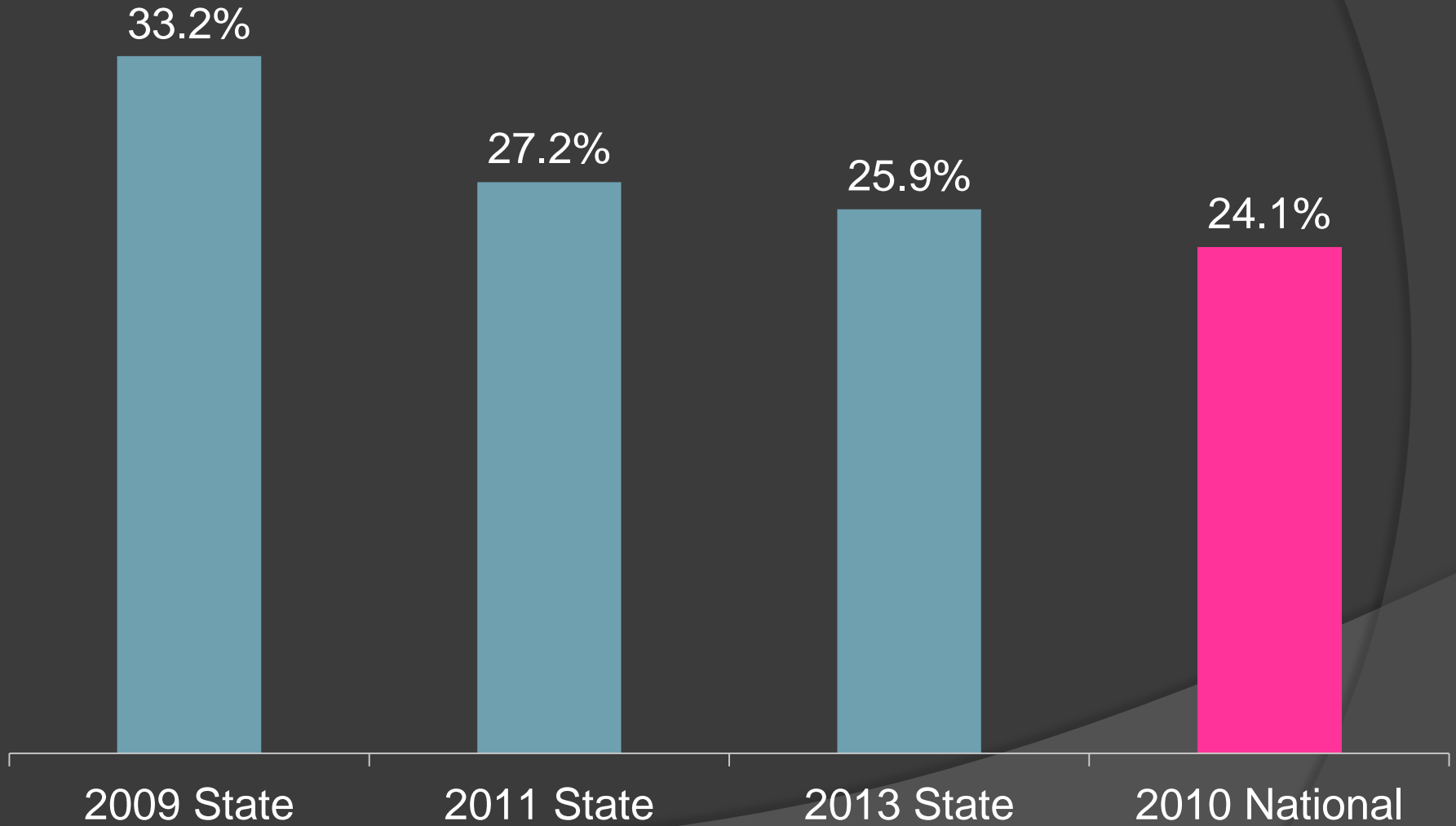

Regional Results: Where's the Party?

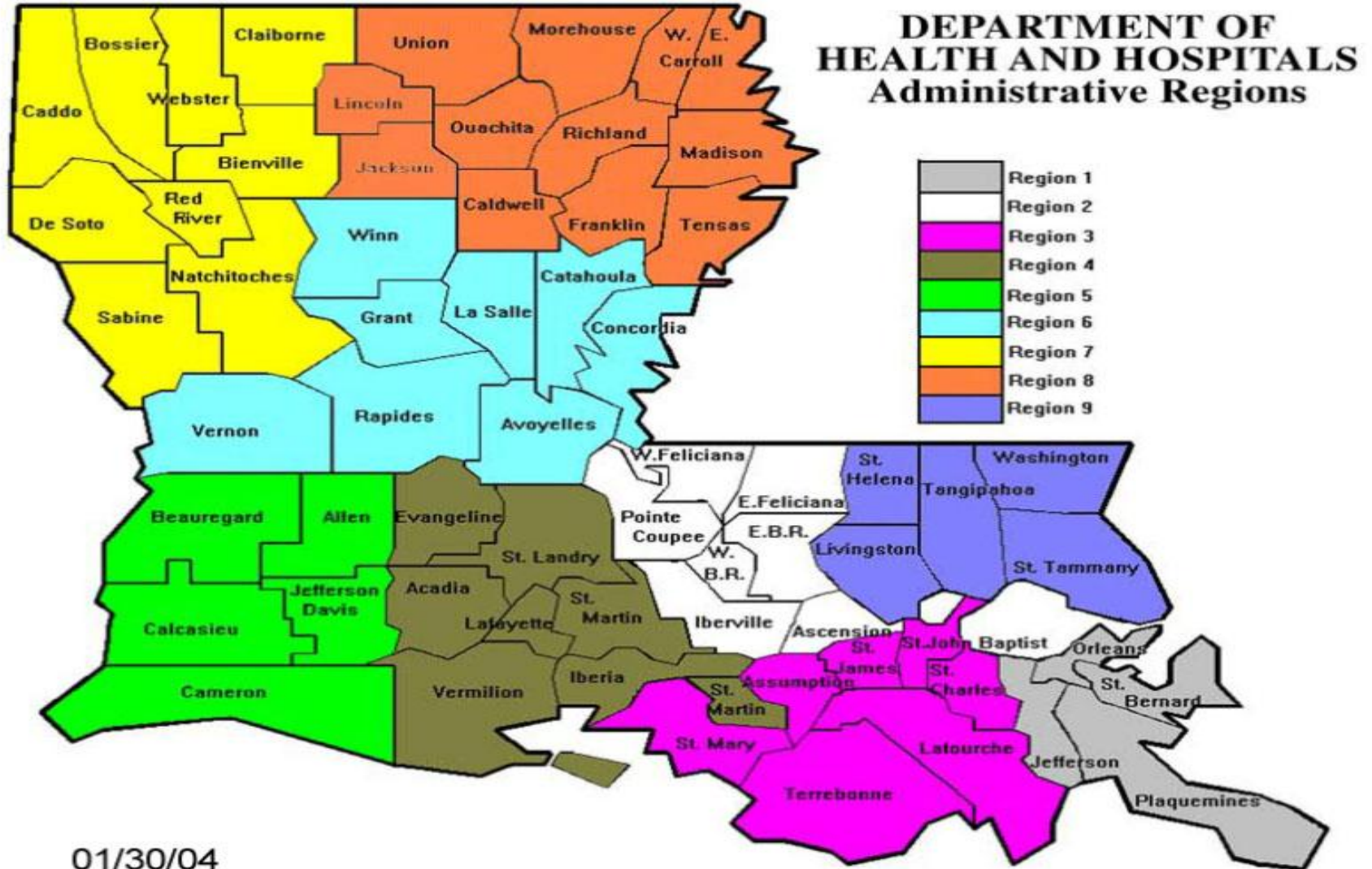

01/30/04

Regional Comparison: 30-Day Alcohol Use

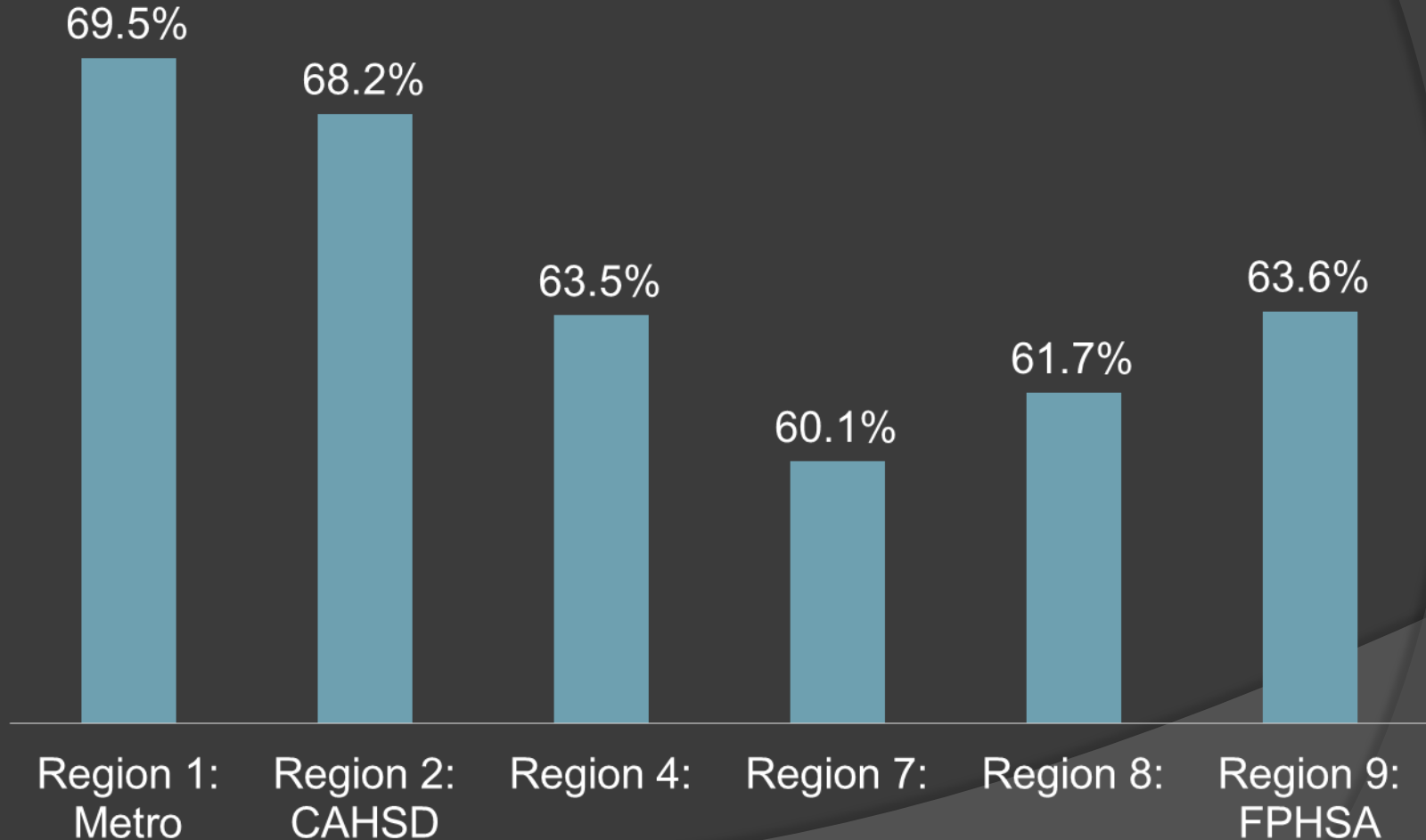

Regional Comparison: Binge Drinking

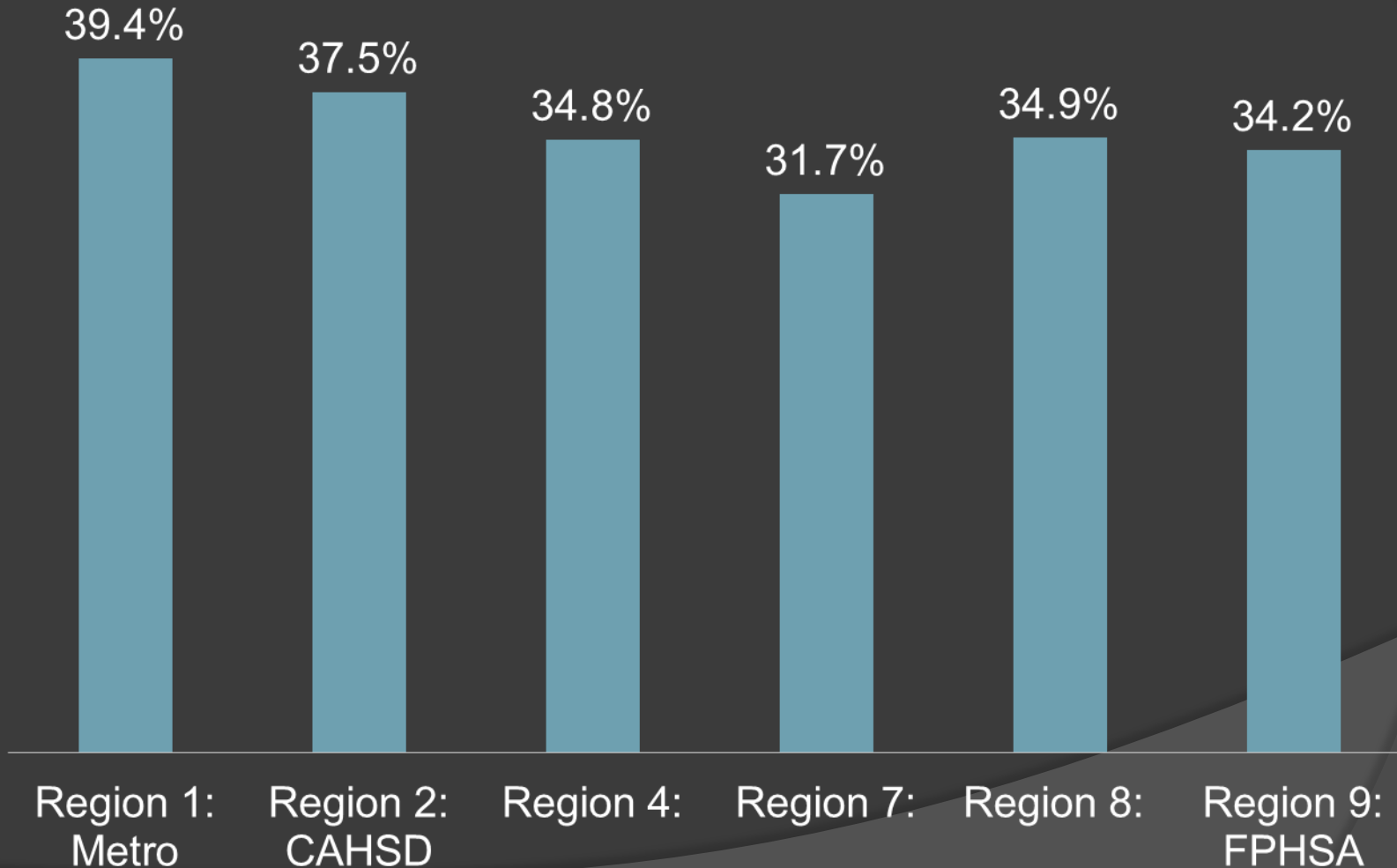

Regional Comparison: 30-Day Tobacco Use

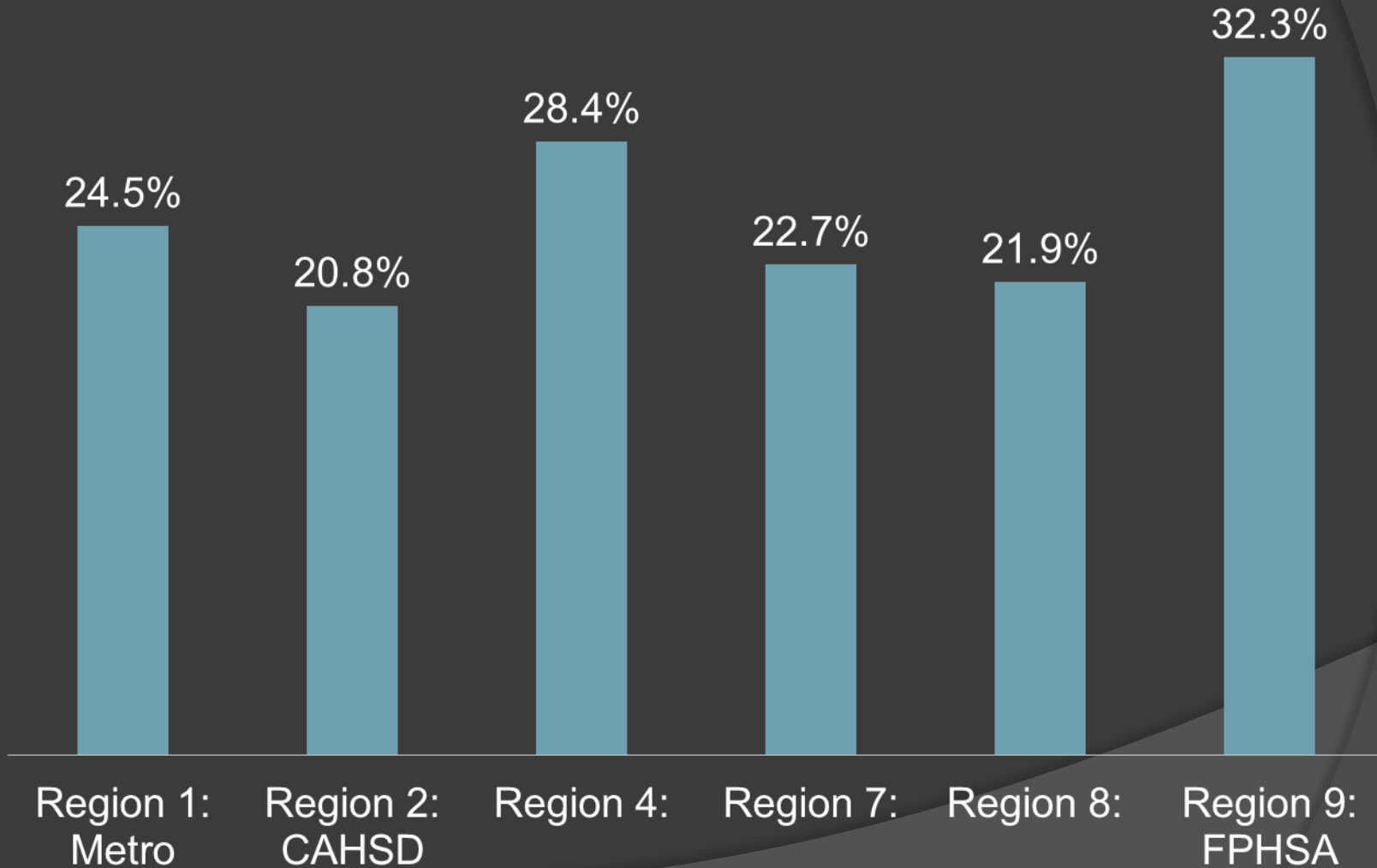

Regional Comparison: 30-Day Marijuana Use

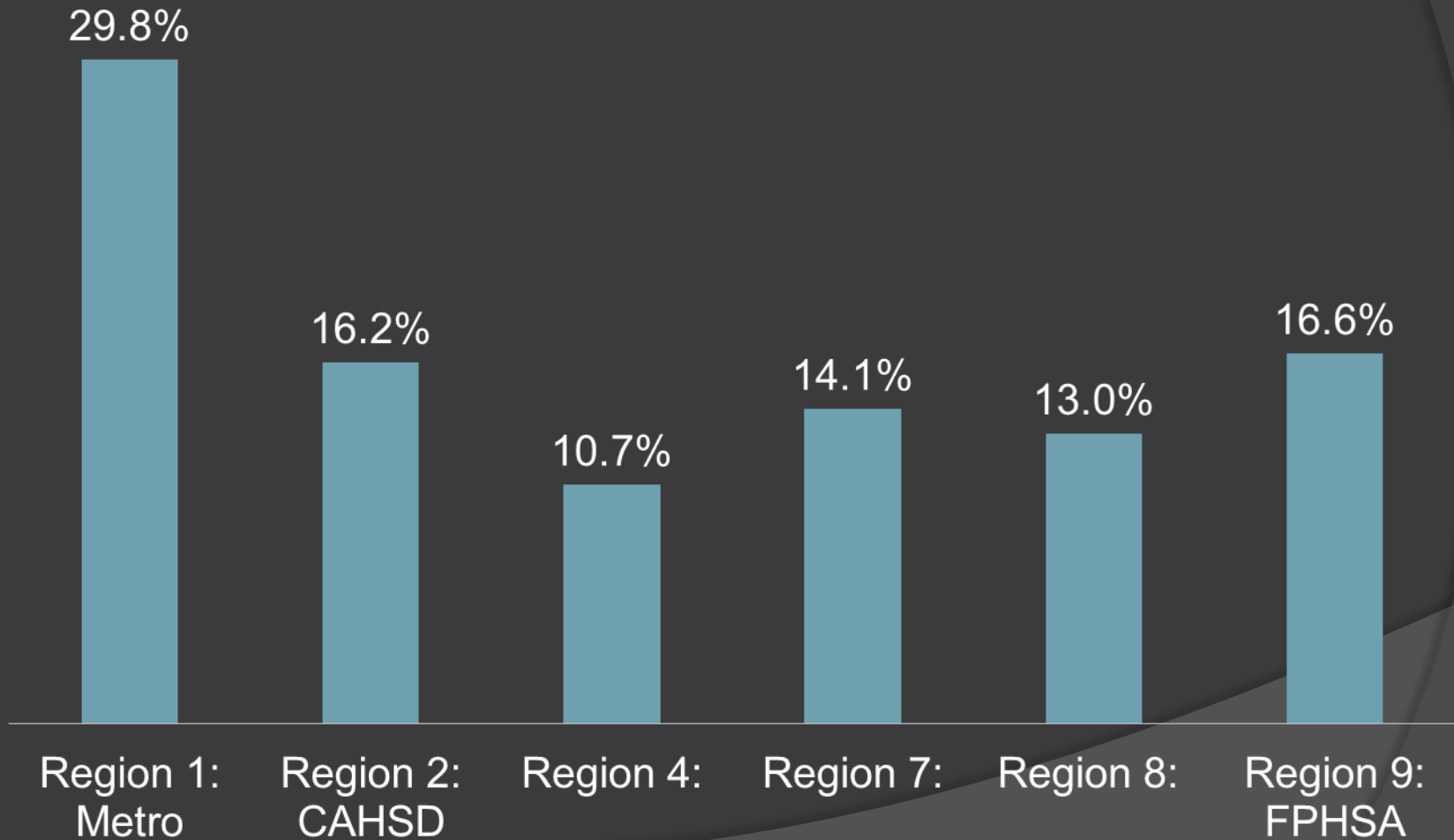

30-Day Other Illegal Drug Use

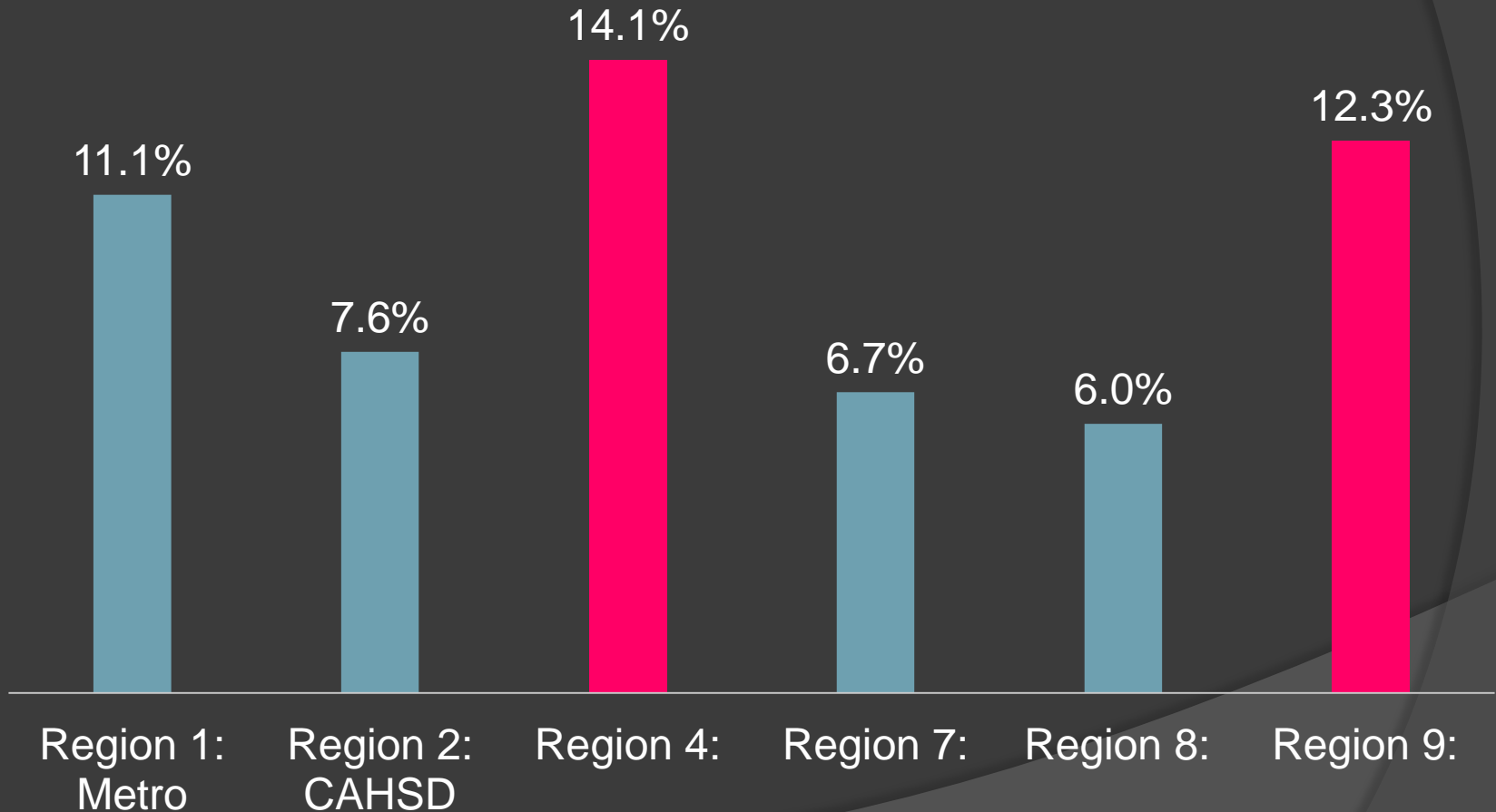

Limitations

- ⦿ Low Response Rates
- ⦿ University Participation
- ⦿ Institutional-level Turnover
- ⦿ Social Desirability Bias
- ⦿ Online low response rates
- ⦿ Oversampling of females

ATOD PREVENTION IN HIGHER EDUCATION

Support from the Administration

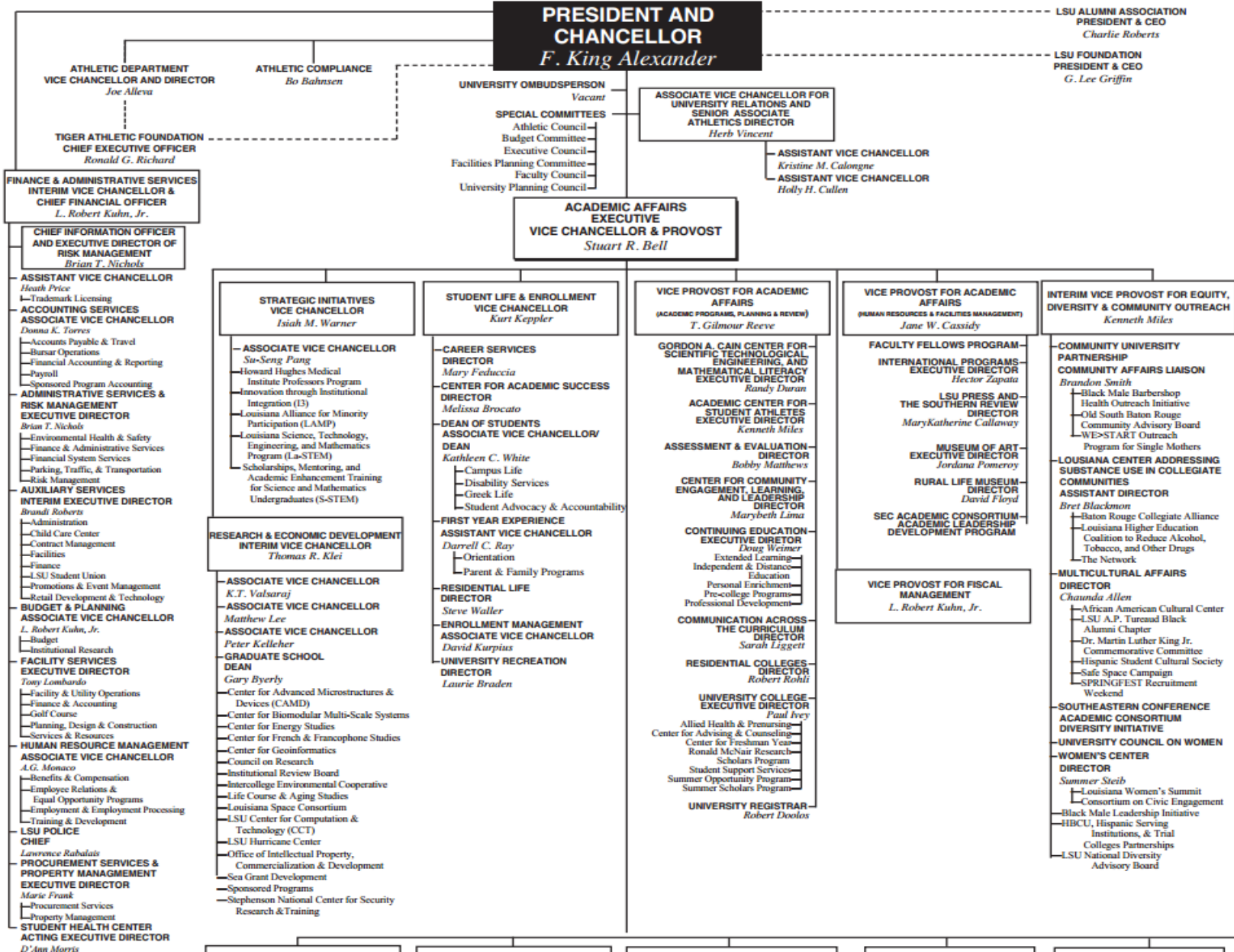

Comprehensive Drug Policy



Proactive Alternatives

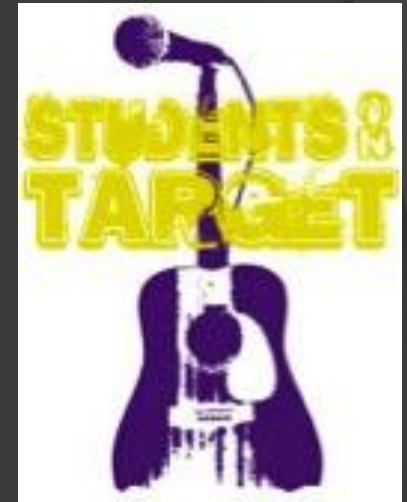

Student Empowerment/Training

LSU Opportunities:

- My Student Body
<http://www.mystudentbody.com/>
- Student Health Advocates (SHA) Peer Educator Application
<http://www.shc.lsu.edu/files/Application.pdf>
- TEAM Class: Tiger Education on Drug/Alcohol Matters
http://www.shc.lsu.edu/index.php?page=wellness_programs
- Alcohol and drug education classes from the LSU Health Center
http://www.shc.lsu.edu/forms/wellness_education_presentation_request.php

Curriculum Infusion



	Monday	Tuesday	Wednesday	Thursday	Friday	Saturday	Sunday
7:00							
8:00	Breakfast--- Transportation	Breakfast--- Transportation	Breakfast--- Transportation	Breakfast--- Transportation	Breakfast--- Transportation		
9:00	History Class	Psychology Class	History Class	Psychology Class	History Class		
10:00	Review History notes, read assignment	↓ Study	Review History notes, read assignment	↓ Transportation	Review History notes	Type Chemistry Lab Report	Revise English paper
11:00	Math Class	Psychology	Math Class	Study Psychology	Math Class	(other typing)	Review History Assignment
12:00	LUNCH--- Math	LUNCH--- Math	English Composition	LUNCH--- Math	English Composition		↓
1:00	↓ Homework	Review Lab Procedure	↓ Class	Math Homework	↓ Class	Draft English paper	↓
2:00	Chemistry Class	Chemistry Class	Chemistry Class	Read Chemistry Class	Chemistry Class	Read Psychology	
3:00	Transportation-- Chemistry Lab	↓ Chemistry Lab	Transportation---	Transportation---	Transportation---	Chapter	Math Homework
4:00						Review Psych. notes	Read and study Chemistry
5:00	Dinner	Transportation ↓ Dinner	Dinner	Dinner	Dinner		
6:00	WORK	Write lab rpt.	WORK		WORK		
7:00	↓	Start reading new Chem. chap., Read Eng. Assign.	↓	Read English assignment Revise compositions	↓		Plan next week's study
8:00							
9:00							
10:00							
11:00							



Community Involvement

LSU's Community Partners:

<http://uiswcmsweb.prod.lsu.edu/edco/lacasu/BRCA/Partnerships/item29458.html>



Environmental Management

“The essence of the environmental management approach is for college officials, working in conjunction with the local community, to change the campus and community environment that contributes to AOD problems.”

*Campus Task Force
Coalition*



Campus and Community



Associations of Colleges and Universities



Drug Testing

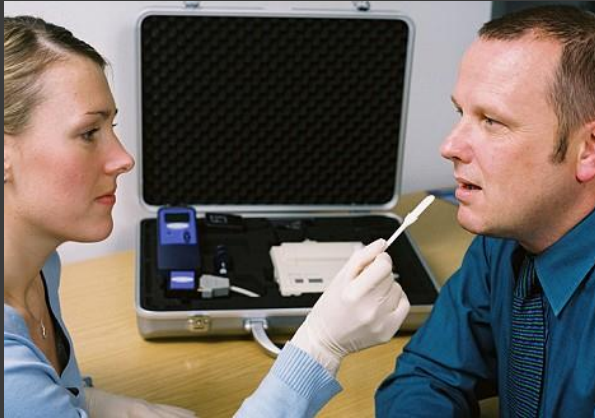

Motivational Interviewing



Recovery Housing (Spotlight: Rutgers)

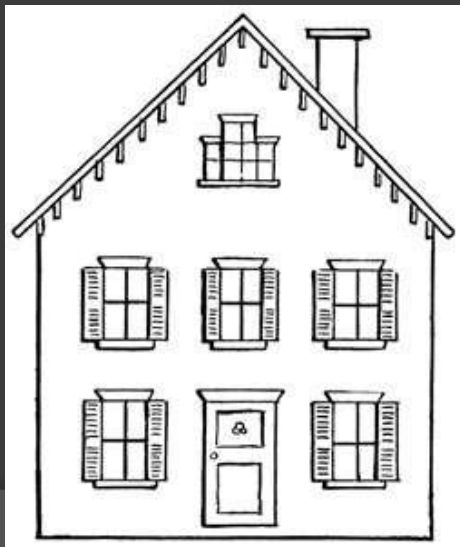

Hotline for Alcohol and Drugs



Social Norming Campaigns

- ◎ Changing the misperceptions
 - Media/Ad campaigns on college campuses
 - Use legitimate data
 - Be creative
 - Avoid 'health terrorism'
 - Use marketing strategies like you would to sell a product
 - Humor, attractiveness, etc.

LSU Interventions

- My Student Body
- TEAM Class
- CARE Team
- Office of Advocacy and Accountability
- Partnership with LSUPD, BRPD, DA, and City Prosecutor
- Redeveloping the campus coalition
- Psyc services
- Mental health counseling
- Outside referrals

Need More Information?

Louisiana Center Addressing Substance Use in Collegiate Communities (LaCASU)

3198 Pleasant Hall
Louisiana State University
Baton, Rouge, LA 70803

lacasu@lsu.edu

phone: 225.578.5958

fax: 225.578.0591

Or you can visit us online (and find a copy of this
presentation) at:

www.lsu.edu/lacasu